

ROCKBRIDGE SPECIFICATIONS



BOX CONSTRUCTION

- 3/4" Particle Board Core with Melamine Paper (Side, Bottom & Top);
- Frameless Construction - Sink Base
- Cabinets have a Plywood Box

DOORS

- 3/4" MDF Core with PVC/Thermofoil Wrap Front; Full Overlay Profile

DRAWER GLIDES

- 3-fold, full extension; ball bearing glides

DRAWER FRONTS

- 3/4" MDF Core with PVC/Thermofoil Wrap Front; Full Overlay Profile

DRAWER BOX

- 3/4" Particle Board Core (Sides & Back);
- 1/4" MDF (Bottom)

SHELVES

- 3/4" Particle Board Core with Melamine Paper; 18" Depth Adjustable

INTERIOR FINISH

- Color Matched to Door & Drawer Fronts

EXTERIOR FINISH

- Color Matched to Door & Drawer Fronts

BACK

- 1/4" MDF Core with Melamine Paper; 3/4" Support Beams (Top & Bottom)

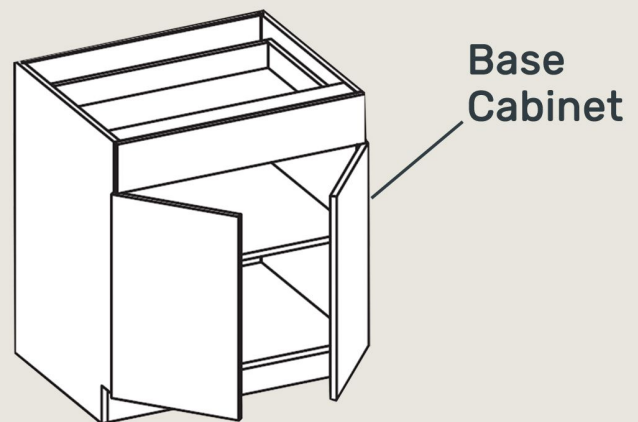
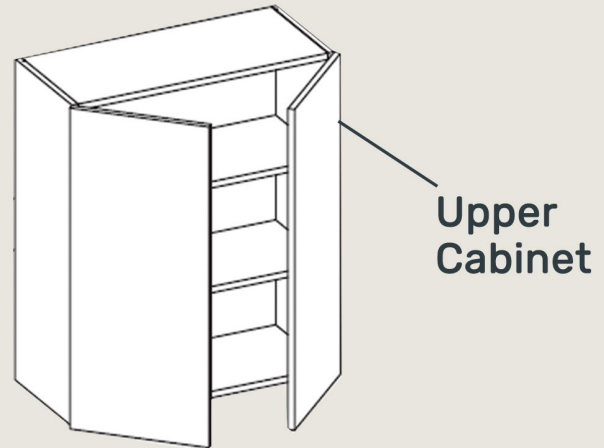

SUPPORT BEAMS

- 3/4" Particle Board Core with Melamine Paper

TOE KICK

- 1/4" Particle Board Core with Melamine Paper

HINGES

- 6-way Adjustable