

CASCADE

MELAMINE SPECIFICATIONS

BOX CONSTRUCTION

- 3/4" Particle Board Core with Melamine Paper (Side, Bottom & Top); Frameless Construction (Dowel & Glue or Cam-Lock Options); Sink Base Cabinets have a Plywood Box with Aluminum Bottom

DOOR FRONTS

- 3/4" MDF Core with Melamine Paper and Matching Edge Band; Full Overlay Profile

DRAWER FRONTS

- 3/4" MDF Core with Melamine Paper and Matching Edge Band; Full Overlay Profile

DRAWER GLIDES

- 3-Fold; Full Extension; Ball Bearing Glides;

SHELVES

- 3/4" Particle Board Core with Melamine Paper; 18" Depth, Adjustable;

DRAWER BOX

- 3/4" Particle Board Core (Sides & Back); 1/4" MDF (Bottom);

INTERIOR FINISH

- Color Matched to Door & Drawer Fronts

EXTERIOR FINISH

- Color Matched to Door & Drawer Fronts

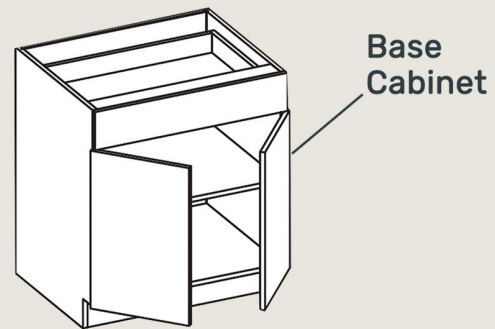
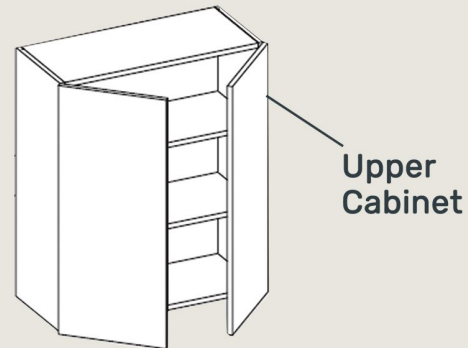

BACKING

- 1/4" MDF Core with Melamine Paper

SUPPORT BEAMS

- 3/4" Particle Board Core with Melamine Paper (2 - Top & Bottom)

TOE KICK

- 3/4" Particle Board Core with Melamine Paper;

HINGES

- 6-Way Adjustable, Soft Close



ASPEN+OZARK
CABINETS